

LOS ANGELES COUNTY
DEPARTMENT OF PUBLIC WORKS

BENCH MARK LIST



LA MIRADA QUAD
NORWALK QUAD
SANTA FE QUAD

1990 ADJUSTMENT

PREFACE 1990

The Department of Public Works level net is composed of more than 1,700 miles of levels supporting in excess of 9,000 bench marks. In 1990, a major readjustment of the Baseline and nets was undertaken. To emphasize the complete break with previous elevations, the CY, CG & CL series bench marks have been relabeled Y, G, & L, respectively.

To facilitate the adjustment, indexing, and distribution of adjusted values of the net, the County territory is divided into 33 quads or areas. For identification purposes each quad is given a name, viz., "Rosemead," "La Mirada," "Santa Fe", etc. When bench marks and elevations in these nets are used, the name of the quad and the date of the adjustment must be included in the bench mark description, e.g.,

Y 9701 - RDBM TAG IN CB 5FT S/O BCR @ SE COR BOLSA ST & DOMINGUEZ ST
63FT S & 20FT E/O C/L INT
(GARDENA - 1990) ELEV. 16.704

Experience indicates that this general adjustment will, for the most part, remain sound for the next 10 years. Updating constrained adjustments will be made in 5 years. It is expected that these updating adjustments will be in the nature of a few hundredths of a foot. When a quad is readjusted, new elevation lists will be published and the date of the readjustment will be noted in the bench mark description. Two bench marks with different adjustment dates will not normally agree with each other.

The basic accuracy of the net is reflected by an indicated field probable error of plus or minus 0.012 foot per mile of leveling as determined from over 600 conditions of closure. However, many years experience in vertical control in the greater Los Angeles basin and Antelope Valley indicate that because of varying degrees of subsidence and heaving, the true datum is recovered only by obtaining substantial agreement of a number of bench marks.

The users of this net are invited to assist in its maintenance by notifying this Department of cases of obliteration, apparent mistakes in descriptions or elevations, and proven disturbance of bench marks.

DATUM: U.S. Coast and Geodetic Survey Sea Level Datum
of 1929, through the medium of the Los Angeles
County Engineer Precise Level Net.

ABBREVIATIONS USED IN BENCH MARK LISTINGS

ABUT -----	Abutment	ECR -----	End of Curb Return
ALG -----	Along	EC -----	End of Curve
ANG PT -----	Angle Point	ENT -----	Entrance
B/W -----	Back of Walk	FL -----	Floor
BCR -----	Beginning of Curb Return	FTG -----	Footing
BC -----	Beginning of Curve	FRWY -----	Freeway
BLDG -----	Building	F/W -----	Front of Walk
BM -----	Bench Mark	GAR -----	Garage
BT SPK -----	Boat or Bolt Spike	HDWL -----	Headwall
BR CAP -----	Brass or Bronze Cap	HSE -----	House
C B -----	Catch Basin	HWY -----	Highway
CTR -----	Center	INT -----	Intersection
C/L -----	Center Line	IP -----	Iron Pipe
C/L INT -----	Center Line Intersection	LT -----	Left
C/L PROD -----	Center Line Produced	LACE -----	L.A. City Engineer
CONC -----	Concrete	LACS -----	L.A. Co. Engineer
COR -----	Corner	LAFC -----	L.A. Co. Flood Control
COE -----	Corps of Engineers	L&BN -----	Lead and Bench Nail
CULV -----	Culvert	L&BR -----	Lead and Brad
CYN -----	Canyon	L&N -----	Lead and Nail
CB -----	Curb	L&SPK -----	Lead and Spike
CS MON -----	Co. Eng. Monument	L&T -----	Lead and Tack
CT SPK -----	Cut Spike	MCR -----	Middle of Curb Return
DPW -----	Dept. of Public Works	MKD -----	Marked
DR -----	Drive or Driveway	MC -----	Middle of Curve
E/O -----	East of	MON -----	Monument

ABBREVIATIONS USED IN BENCH MARKS (CON'T)

N/O ----- North of
NR ----- Near
OPP ----- Opposite
PI ----- Point of Intersection
PK&W ----- PK Nail and Washer
P/L ----- Property Line
POST ----- Point of Semi-Tangent
PP ----- Power Pole
PVMT ----- Pavement
PROD ----- Produced
RD ----- Road
RDBM ----- Road Dept. Bench Mark
RDBM TAG ----- Road Dept. Bench Mark Tag
RR ----- Railroad
RT ----- Right
R/W ----- Right of Way
SDMH ----- Storm Drain Manhole
SMH ----- Sewer Manhole
SPK ----- Spike
ST&W ----- Spike Tin and Washer
S/O ----- South of
TP ----- Telephone Pole
USC&GS ----- U.S. Coast and Geodetic Survey
USGS ----- U.S. Geological Survey
WK ----- Walk
W/O ----- West of

QUAD

SANTA FE

QUAD

NORWALK

ARTESIA QUAD

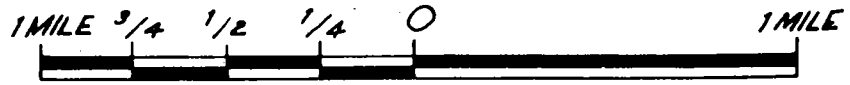
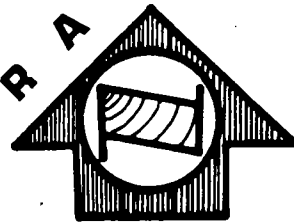
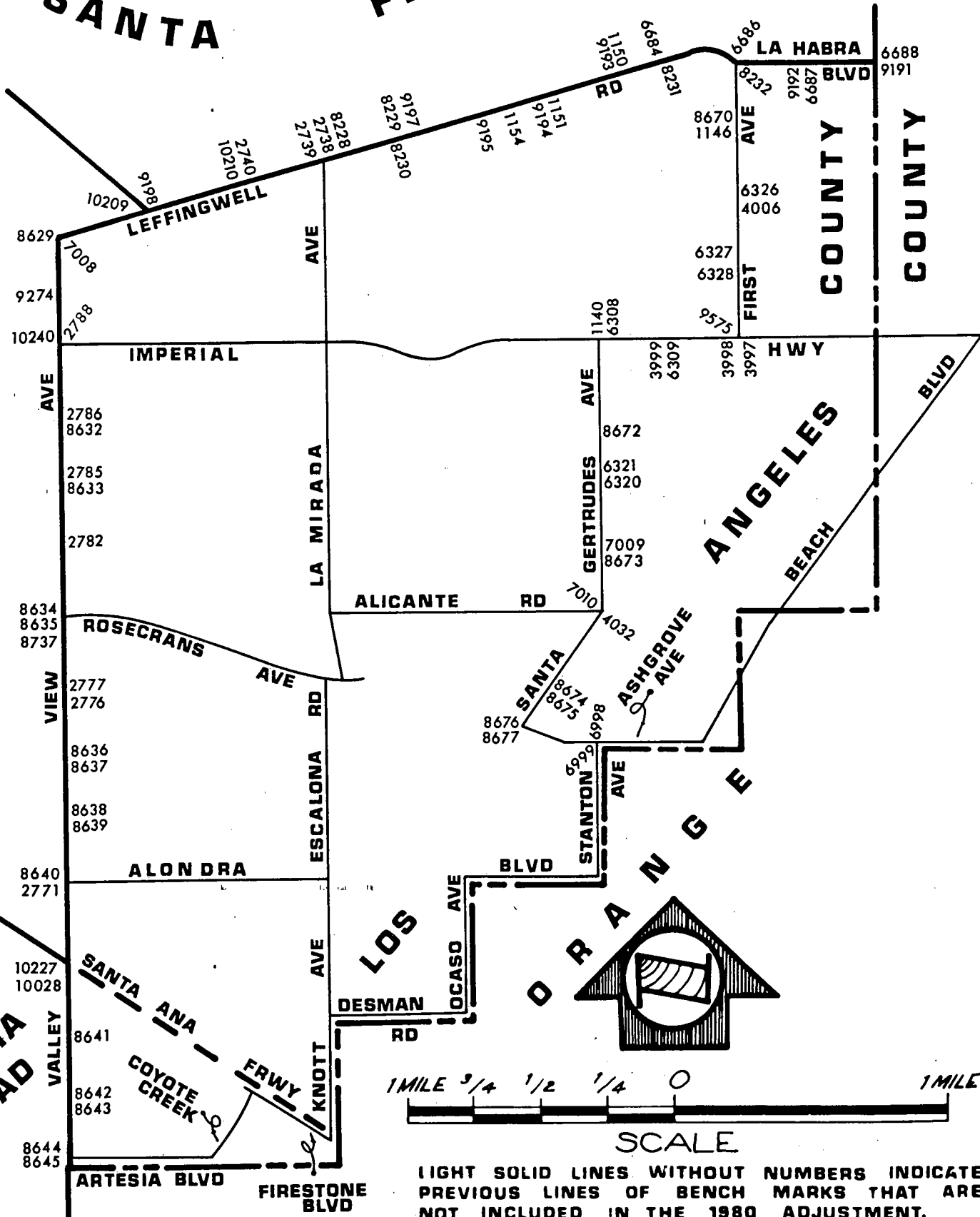

SCALE

LIGHT SOLID LINES WITHOUT NUMBERS INDICATE PREVIOUS LINES OF BENCH MARKS THAT ARE NOT INCLUDED IN THE 1980 ADJUSTMENT.

LA MIRADA QUAD

G U A D R I V E R A Q U A D

G A T E

N O R W A L K

A R T E S I A

B E L L F L O W E R

Q U A D

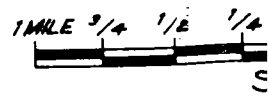
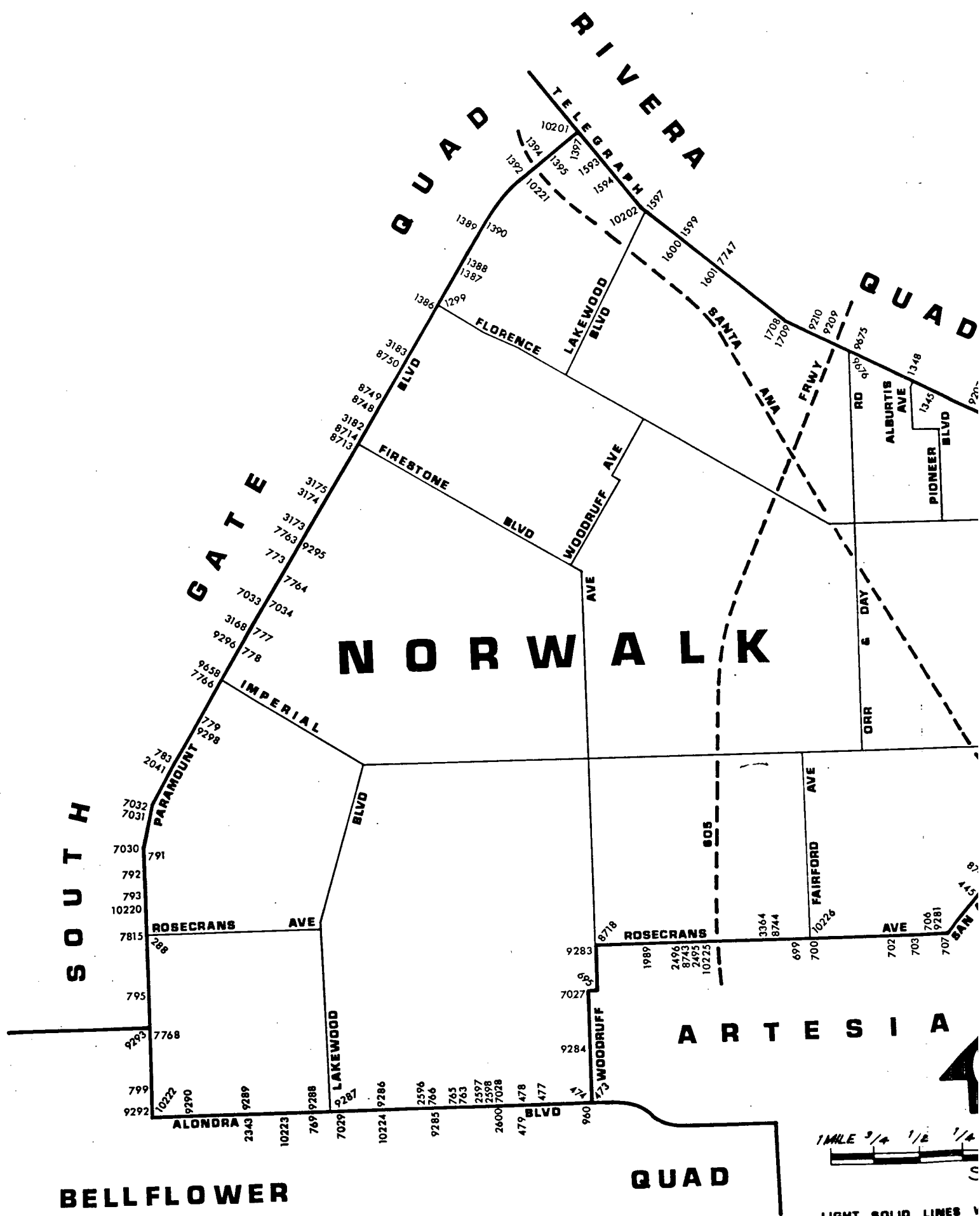

LIGHT SOLID LINES &
PREVIOUS LINES OF
NOT INCLUDED IN T

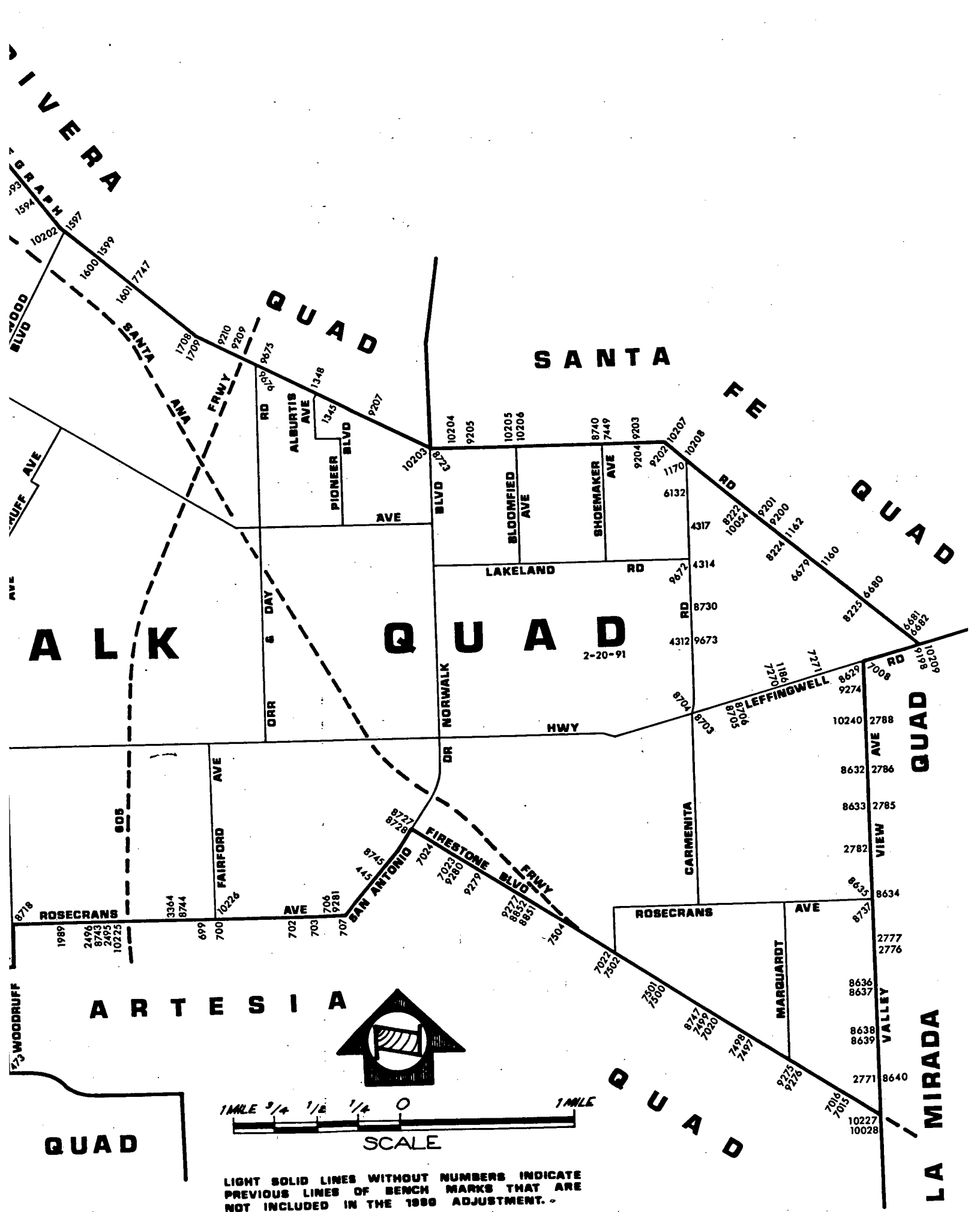

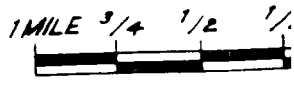
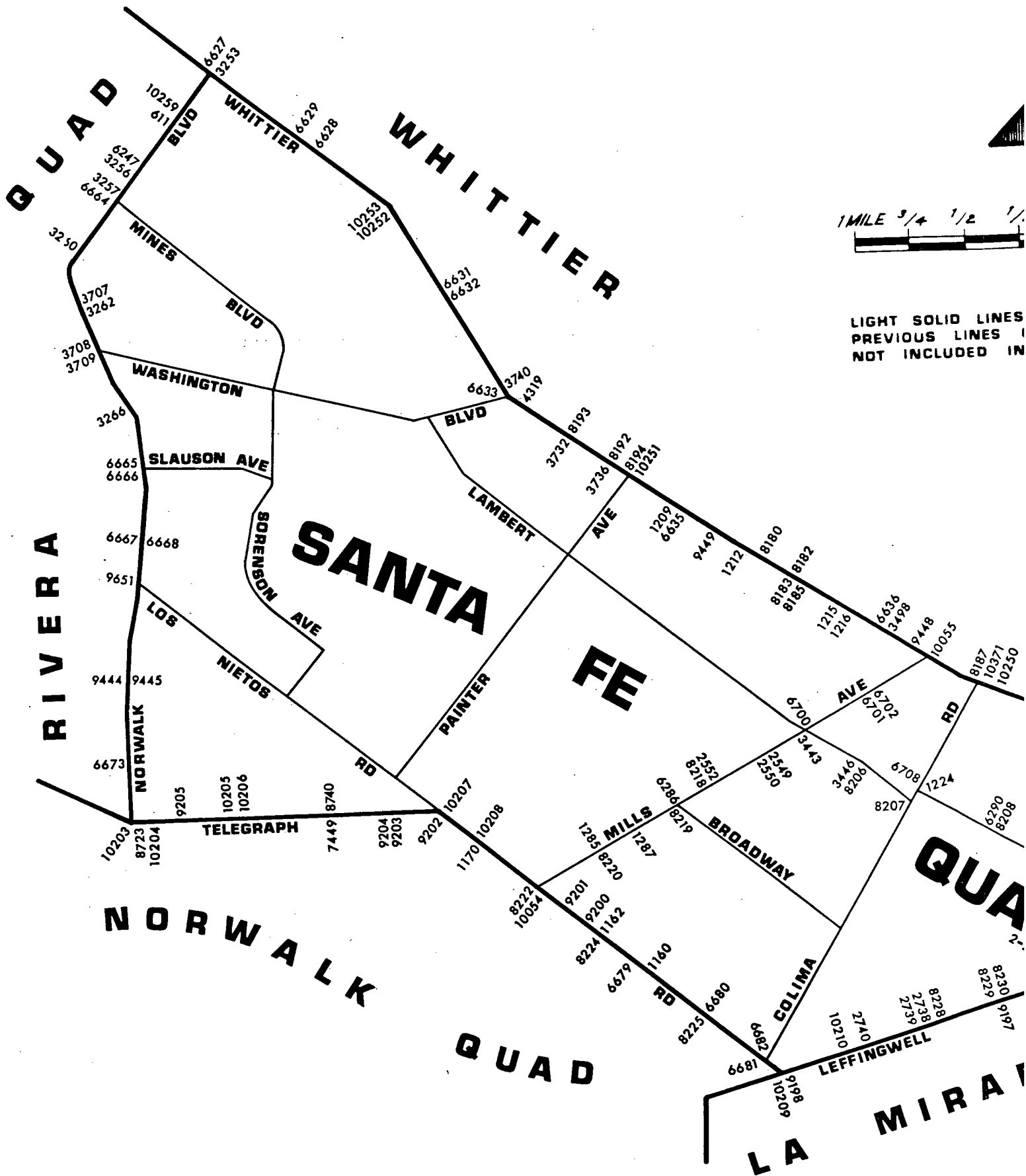

LIGHT SOLID LINES
PREVIOUS LINES
NOT INCLUDED IN

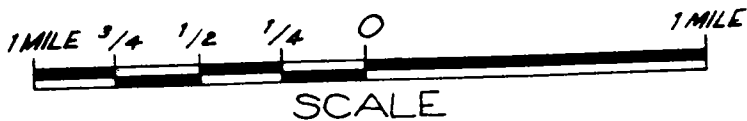
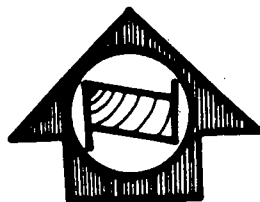

LIGHT SOLID LINES WITHOUT NUMBERS INDICATE PREVIOUS LINES OF BENCH MARKS THAT ARE NOT INCLUDED IN THE 1980 ADJUSTMENT.

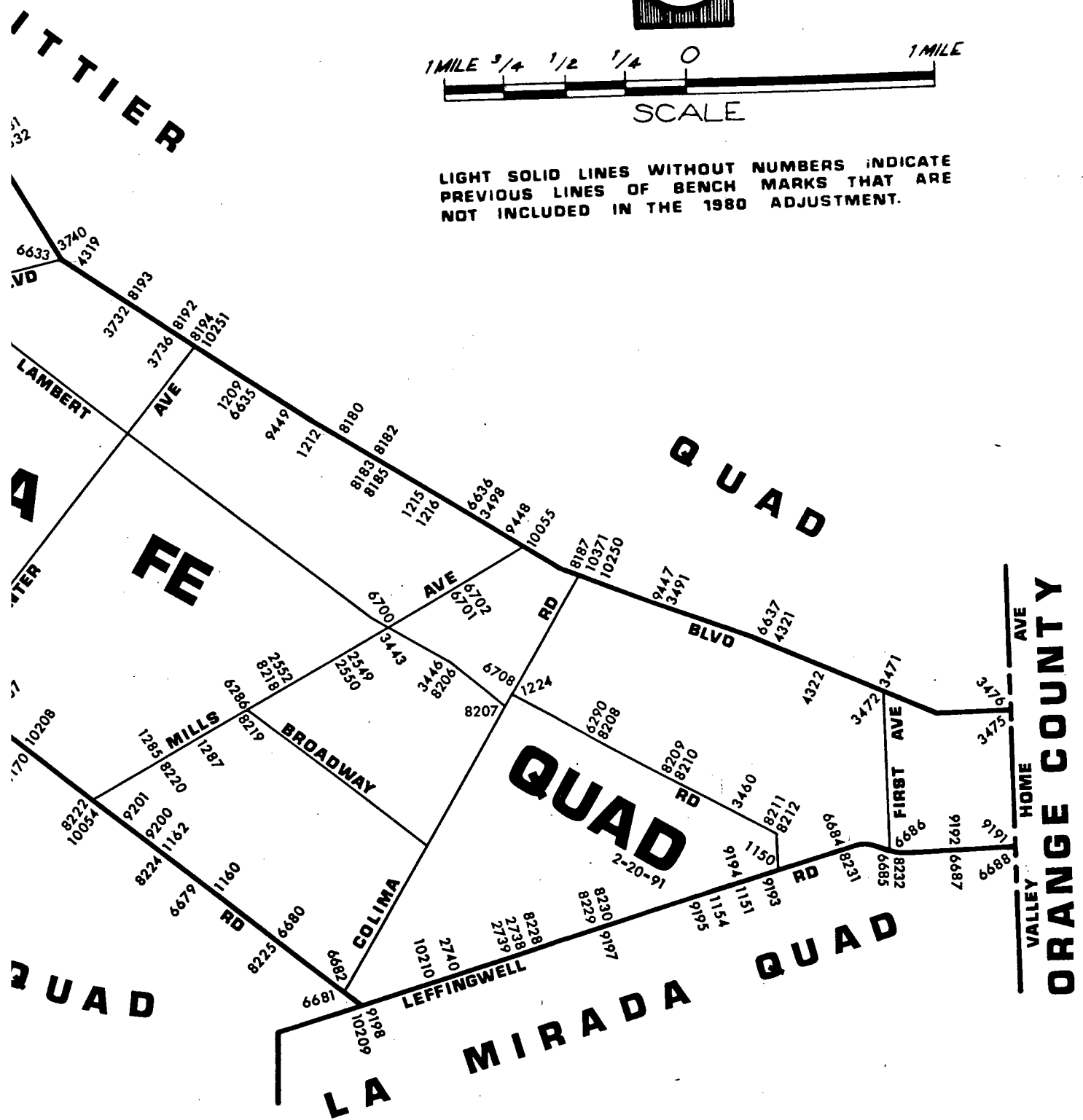

QUAD-YEAR	ELEV	DESCRIPTION (INCLUDE QUAD AND YEAR IN DESCRIPTION)	BM NUMBER
BASELINE (1990)	73.374	4.5 IN IP WITH L&T 6IN BACK WK ON SE COR PARAMOUNT BLVD & ROSECRANS AVE 244FT S C/L 50FT E C/L INT MKD (LAC 32)	DY 288
BASELINE (1990)	92.706	L&T 5FT E CB RET @ NE COR SYCAMORE ST & SAN ANTONIO DR 74FT E & 18FT N C/L INT	DY 445
BASELINE (1990)	73.078	CS REF MON IN WELL 14IN DN ON NE COR ALONDRA BLVD & WOODRUFF AVE 56FT N & 60FT E/O C/L INT MKD (CLEARWATER K 2A)	DY 473
BASELINE (1990)	73.716	CSBM MON FL ON NW COR ALONDRA BLVD & WOODRUFF AVE 39FT N & 180FT W C/L INT MKD (BM 6-6A1958)	DY 474
BASELINE (1990)	74.704	L&N IN E CB 18FT E/O C/L EUCALYPTUS AVE & 80FT S/O C/L ALONDRA BLVD (15FT W/O BCR)	DY 477
BASELINE (1990)	75.143	L&T IN E CB 15FT E/O C/L LEAHY AVE & 80FT N/O C/L ALONDRA BLVD (27FT N/O BCR)	DY 478
BASELINE (1990)	75.121	L&T IN W CB 15FT W/O C/L LEAHY AVE & 80FT N/O C/L ALONDRA BLVD (14FT N/O BCR)	DY 479
BASELINE (1990)	169.272	L&SPK CTR OF WK 3FT E FLAGPOLE @ WEST WHITTIER SCHOOL 51FT W C/L NORWALK BLVD & 250FT N C/L BEXLEY DR TO THE W	DY 611
BASELINE (1990)	80.757	RD HD SPK&L W CB 28FT N BCR @ NW COR WOODRUFF AVE & WASHINGTON ST 70FT N & 40FT W C/L INT MKD (MV 26)	DY 695
BASELINE (1990)	84.340	L&N 1FT E BCR @ SE COR ROSECRANS AVE & CROSSDALE AVE 40FT S & 50FT E C/L INT	DY 699
BASELINE (1990)	84.617	L&N 1FT E BCR @ SE COR ROSECRANS AVE & ELMCROFT AVE 40FT S & 50FT E C/L INT	DY 700
BASELINE (1990)	85.011	L&N 1FT E BCR @ SE COR ROSECRANS AVE & GARD AVE 38FT S & 50FT E C/L INT	DY 702
BASELINE (1990)	86.606	L&N 1FT S BCR @ SE COR ROSECRANS AVE & JERSEY AVE 68FT S & 18FT E C/L INT	DY 703
BASELINE (1990)	86.339	CS MON IN WELL 13IN DN ON NW COR ROSECRANS AVE & PIONEER BLVD 86FT N & 40FT W C/L INT MKD (WHITTIER C 124 1959)	DY 706
BASELINE (1990)	86.879	RDBM MON FLUSH IN CONC SQ POST ON SW COR ROSECRANS AVE & ARLEE AVE 83FT S & 20FT W C/L INT MKD (BM 184)	DY 707

QUAD-YEAR	ELEV	DESCRIPTION (INCLUDE QUAD AND YEAR IN DESCRIPTION)	BM NUMBER
BASELINE (1990)	71.731	L&T 2FT W CB RET NW COR RYON AVE & ALONDRA BLVD 38FT N & 32FT W C/L INT	DY 763
BASELINE (1990)	73.595	L&BN S CB ALONDRA BLVD 6IN E CB RET @ SE COR ALONDRA BLVD & PACIFIC AVE 70FT W PERR	DY 765
BASELINE (1990)	68.544	L & SPK 4FT E CB RET @ NE COR CLARK AVE & ALONDRA BLVD 38FT N & 59FT E C/L INT	DY 766
BASELINE (1990)	68.320	L&T C/L INT PITTS AVE & ALONDRA BLVD	DY 769
BASELINE (1990)	108.324	L&SPK IN WK 55FT N/O C/L COLE ST (TO THE WEST) & 50FT W/O C/L PARAMOUNT BLVD MKD (0_31)	DY 773
BASELINE (1990)	104.780	L&T 14FT E C/L PARAMOUNT BLVD 11FT N C/L SPRINGER ST PROD IN CONC PVMT	DY 777
BASELINE (1990)	103.878	L&T IN CONC 14FT E C/L PARAMOUNT BLVD 4FT N C/L QUILL DR PROD	DY 778
BASELINE (1990)	90.338	L & T 1FT N BCR @ NE COR PARAMOUNT BLVD & ADOREE AVE 58FT N & 38FT E C/L INT	DY 779
BASELINE (1990)	82.506	CS MON 16FT W & 5FT S INT PARAMOUNT BLVD & GARDENDALE ST	DY 783
BASELINE (1990)	77.706	L & T 10FT S BCR INTO CB RET @ NE COR PARAMOUNT BLVD & CENTURY BLVD 2FT N & 41FT E C/L INT	DY 791
BASELINE (1990)	76.227	BT SPK 1FT S BCR @ SW COR PARAMOUNT BLVD & PEARLE ST 32FT S & 38FT W C/L INT MKD (H-110)	DY 792
BASELINE (1990)	75.474	BT SPK BCR @ SW COR PARAMOUNT BLVD & HOWE ST 30FT S & 38FT W C/L INT	DY 793
BASELINE (1990)	71.487	L & T IN CB 38FT W C/L PARAMOUNT BLVD ON THIRD ST C/L PROD	DY 795
BASELINE (1990)	68.482	L&T W CB PARAMOUNT BLVD 2FT N CB RET @ NW COR MADISON ST & PARAMOUNT BLVD	DY 799
BASELINE (1990)	73.470	L&T IN S CB ALONDRA BLVD 1FT E INTO RET 68FT W C/L WOODRUFF AVE & 38FT S/O C/L ALONDRA BLVD	DY 960
LAMIRADA (1990)	256.787	CS MON IN WELL 12IN DN @ OR NR C/L INT IMPERIAL HWY & SANTA GERTRUDES AVE MKD (AUX LA HABRA A 10 A)	DY 1140
LAMIRADA (1990)	256.400	RDBM TAG IN W CB 1FT S/O BCR @ SW COR FIRST AVE & SHARONHILL DR 32FT W & 60FT S C/L INT	DY 1146

QUAD-YEAR	ELEV	DESCRIPTION (INCLUDE QUAD AND YEAR IN DESCRIPTION)	BM NUMBER
BASELINE (1990)	241.281	L&BN IN CB 36FT E BCR @ NE COR LEFFINGWELL RD & SANTA GERTRUDES AVE 40FT N & 145FT E C/L INT 1FT W/O ENT CATCH BASIN	DY 1150
BASELINE (1990)	234.479	L&BN IN CB 40FT S C/L LEFFINGWELL RD & 36 FT E/O C/L PROD EL ARCO DR	DY 1151
BASELINE (1990)	228.499	CS MON IN WELL 12IN DN 40FT S/O C/L LEFFINGWELL RD 2FT S/O S CB & 619FT E/O C/L SCOTT AVE MKD (RM 2 LA HABRA A 9 1960)	DY 1154
BASELINE (1990)	175.232	L&SPK N BCR @ NE COR TELEGRAPH RD & CERES ST 61FT N & 20FT E C/L INT MKD (WZ 399)	DY 1160
BASELINE (1990)	134.362	L&T N CB 1FT W BCR @ NW COR TELEGRAPH RD & VICTORIA AVE 42FT N & 48FT W C/L INT	DY 1162
BASELINE (1990)	156.152	CS MON IN WELL 14IN DN 15FT S & 25FT E C/L INT TELEGRAPH RD & CARMENITA RD MKD (WHITTIER G 8 1942)	DY 1170
NORWALK (1990)	109.084	L&T ELY CB 7FT NLY BCR @ NELY COR LEFFINGWELL RD & MEYER RD 48FT NLY & 40FT ELY APPROX C/L INT	DY 1186
BASELINE (1990)	237.939	RDBM TAG IN CONC RETAINING WALL 6FT S CB FACE 54FT S & 45FT W C/L INT WHITTIER BLVD & LAUREL	DY 1209
BASELINE (1990)	236.338	L&T IN N CB PKWY @ BCR 48FT S & 30FT W/O C/L INT WHITTIER BLVD & BOYER AVE	DY 1212
BASELINE (1990)	266.123	L&SPK S CB WHITTIER BLVD 40FT S/O C/L & 136FT E/O C/L PROD CATALINA AVE MKD (WZ127)	DY 1215
BASELINE (1990)	264.216	L & T 1FT W BCR 40FT S & 30FT W C/L INT GUNN AVE & WHITTIER BLVD	DY 1216
SANTA FE (1990)	204.672	L&T W CB COLIMA RD 35FT S/O C/L & 42FT W/O C/L CARNELL AVE	DY 1224
SANTA FE (1990)	137.876	L & T NE COR CONC WK @ SW COR MILLS AVE & CLOSE ST 100FT W & 53 S C/L INT	DY 1285
SANTA FE (1990)	142.351	L & T 2FT S BCR @ SE COR MILLS AVE & ANOLA ST 30FT E & 37FT S C/L INT	DY 1287
BASELINE (1990)	125.683	RDBM TAG N CB 1FT E BCR @ NE COR PARAMOUNT BLVD & FLORENCE AVE 40FT N & 68FT E C/L INT	DY 1299

QUAD-YEAR	ELEV	DESCRIPTION (INCLUDE QUAD AND YEAR IN DESCRIPTION)	BM NUMBER
BASELINE (1990)	131.013	RDBM TAG IN S CB TELEGRAPH RD 2FT W/O SW CB RET @ MAIN DRWY TO SANTA FE SPRINGS FIRE STA BLDG NO 11736 40FT S/O C/L TELEGRAPH RD & 390FT W/O C/L PIONEER BLVD	DY 1345
BASELINE (1990)	131.376	CS MON IN WELL @ C/L INT TELEGRAPH RD & ALBURTIS AVE NLY MKD (LACS CON SYS TRA STA WHITTIER B-7 RE2177 1941)	DY 1348
BASELINE (1990)	124.365	CS BR CAP CONC MON IN WELL @ C/L INT PARAMOUNT BLVD & FLORENCE AVE	DY 1386
BASELINE (1990)	127.087	L & BRAD CTR CB RET SE COR LUBEC ST & PARAMOUNT BLVD 25FT S & 52FT E C/L INT	DY 1387
BASELINE (1990)	127.305	L & BRAD CTR CB RET NE COR LUBEC ST & PARAMOUNT BLVD 27FT N & 52FT E C/L INT	DY 1388
BASELINE (1990)	130.241	L&BN W CB PARAMOUNT BLVD @ NLY P L HSE NO 9603 33FT W/O C/L PARAMOUNT BLVD	DY 1389
BASELINE (1990)	131.723	L & T CONC CB @ BCR SE COR SUVA ST & PARAMOUNT BLVD 48FT S & 38FT E C/L INT MKD (BM)	DY 1390
BASELINE (1990)	134.141	L & T IN CONC CB @ BCR @ SW COR GALLATIN RD & PARAMOUNT BLVD 53FT S & 38FT W C/L INT	DY 1392
BASELINE (1990)	138.375	SQ HD SPK W CB OF SERVICE RD OF PARAMOUNT BLVD 12FT N C/L PROD BROOKGREEN RD	DY 1394
BASELINE (1990)	139.325	L&BR E CB 1FT S/O BCR @ SE COR PARAMOUNT BLVD & VISTA DEL ROSA SERVICE ISLAND 40FT E & 50FT S C/L INT	DY 1395
BASELINE (1990)	141.886	CS MON IN WELL 8IN DN ON C/L TELEGRAPH RD 20FT WLY C/L PARAMOUNT BLVD MKD (BELL K4 1941)	DY 1397
BASELINE (1990)	142.489	L&BN 4FT S BCR @ SW COR BIRCHBARK AVE & TELEGRAPH RD 80FT S & 18FT W/O C/L INT	DY 1593
BASELINE (1990)	144.834	L&BN 4FT S BCR @ SW COR STAMPS RD & TELEGRAPH RD 78FT S & 18FT W/O C/L INT	DY 1594
BASELINE (1990)	137.654	CS MON MKD (LACO SUR TRAVERSE STA BELL K-5A RE2177 1941) IN WELL W/COVER @ CL INT TELEGRAPH RD & LAKEWOOD BLVD	DY 1597
BASELINE (1990)	138.219	L&T S END W GAS ISLAND NE COR TELEGRAPH RD & SERAPIS AVE 67FT N & 61FT E/O C/L INT MKD (AT 31)	DY 1599

QUAD-YEAR	ELEV	DESCRIPTION (INCLUDE QUAD AND YEAR IN DESCRIPTION)	BM NUMBER
BASELINE (1990)	136.991	L&T IN S CB TELEGRAPH RD 6FT W/O CB RET @ SE COR SERAPIS AVE 40FT S & 50FT E/O C/L INT	DY 1600
BASELINE (1990)	140.980	L&BN 1FT FROM BCR SERVICE RD N CB @ PASSONS BLVD & TELEGRAPH RD 50FT S C/L TELEGRAPH RD	DY 1601
BASELINE (1990)	137.016	L&B W ECR @ SW COR TRUE AVE & TELEGRAPH RD (SERVICE RD) 47FT W & 15FT S/O C/L INT TRUE AVE & TELEGRAPH RD (SERVICE RD)	DY 1708
BASELINE (1990)	137.094	CS BR CAP CONC MON IN CASING & COVER PI 6.82FT E C/L INT TRUE AVE & TELEGRAPH RD	DY 1709
BASELINE (1990)	89.881	RDBM TAG S CB ROSECRANS AVE 40FT S C/L @ ANG PT OF CB TO BRIDGE OVER SAN GABRIEL RIVER 500FT W BRIDGE	DY 1989
BASELINE (1990)	83.296	L & T 6FT W BCR @ SW COR PARAMOUNT BLVD & GARDENDALE ST 35FT S & 59FT W C/L INT	DY 2041
BASELINE (1990)	66.136	L&T CTR CB RET @ SE COR ALONDRA BLVD & DOWNEY AVE 48FT S & 47FT E C/L INT	DY 2343
BASELINE (1990)	98.696	L&BN N CB ROSECRANS AVE NE COR BRIDGE OVER SAN GABRIEL RIV 1FT W OF E END OF BRIDGE 23FT N C/L ROSECRANS AVE	DY 2495
BASELINE (1990)	101.045	L&BN N CB ROSECRANS AVE @ NW COR BRIDGE OVER SAN GABRIEL RIV 1FT E OF W END OF BRIDGE 23FT N C/L ROSECRANS AVE	DY 2496
SANTA FE (1990)	185.325	L & T NE COR CONC STEP HSE NO 9665 60FT W C/L MILLS AVE & 550FT S LAMBERT RD	DY 2549
SANTA FE (1990)	176.402	L&T NE COR CONC STEP HSE NO 9753 MILLS AVE 60FT W C/L 1050FT S LAMBERT RD	DY 2550
SANTA FE (1990)	156.148	L&T N CB 6FT W BCR @ NW COR MILLS AVE & MULBERRY DR 40FT N & 68FT W C/L INT	DY 2552
BASELINE (1990)	67.343	LACS MON 30FT N & 70FT E C/L INT ALONDRA BLVD & CLARK AVE MKD(BM 6-8 1951)	DY 2596
BASELINE (1990)	73.236	L&T N CB 4FT W CB RET @ NW COR ALONDRA BLVD & BLAINE AVE 38FT N & 35FT W C/L INT	DY 2597
BASELINE (1990)	73.370	L&T IN N CB 3FT E CB RET @ NE COR ALONDRA BLVD & BLAINE AVE 38FT N & 32FT E C/L INT	DY 2598
BASELINE (1990)	74.081	L&BN S CB 1FT W CB RET @ SW COR ALONDRA BLVD & BELLFLOWER BLVD 46FT W & 38FT S C/L INT	DY 2600

QUAD-YEAR	ELEV	DESCRIPTION (INCLUDE QUAD AND YEAR IN DESCRIPTION)	BM NUMBER
BASELINE (1990)	216.568	L&T IN DEP CB DRWY TO GAS STATION 2FT E/O BCR @ NW COR LA MIRADA BLVD & LEFFINGWELL RD 40FT N & 60FT W/O C/L INT	DY 2738
BASELINE (1990)	216.693	L & T IN S CB 7FT E BCR 41FT S & 50FT W C/L INT LEFFINGWELL RD & LA MIRADA BLVD	DY 2739
BASELINE (1990)	191.452	L&BN W END CATCH BASIN N SIDE LEFFINGWELL RD 40FT N C/L & 450FT W C/L LA MIRADA BLVD 500FT E C/L ARROYO DR	DY 2740
BASELINE (1990)	65.249	L&BN W CB 7FT N OF BCR @ SW COR ALONDRA BLVD & VALLEY VIEW AVE 68FT S & 40FT W C/L INT	DY 2771
BASELINE (1990)	94.594	L&SPK N CB 4FT E BCR @ NE COR VALLEY VIEW AVE & STAGE RD 30FT N & 60FT E C/L INT CB MKD (RBM 1)	DY 2776
BASELINE (1990)	94.628	USC&GS MON FLUSH ON NE COR VALLEY VIEW AVE & STAGE RD 31.5FT N & 87FT E C/L INT 1.5FT N CB MKD (K 778-1945)	DY 2777
BASELINE (1990)	94.139	L&BN NR CTR OF BRIDGE NO 1273 40FT E/O C/L VALLEY VIEW AVE 800FT S FOSTER RD 137FT N C/L MAZSA DR	DY 2782
BASELINE (1990)	94.589	CS MON IN WELL 10IN DN ON NE COR VALLEY VIEW AVE & FOSTER RD 62FT N & 41FT E C/L INT 1FT BACK CB MKD (BM 1#6A 1961)	DY 2785
BASELINE (1990)	105.857	L&BN E CB 1FT N BCR @ NE COR VALLEY VIEW AVE & ADOREE ST TO THE E 57FT N & 38FT E/O C/L INT	DY 2786
BASELINE (1990)	115.778	L&BN E CB 1FT S BCR @ SE COR VALLEY VIEW AVE & IMPERIAL HWY 76FT S & 38FT E C/L INT	DY 2788
BASELINE (1990)	104.256	L & T 18FT S C/L SPRINGER ST & 70FT W C/L PARAMOUNT BLVD 8FT W BCR @ SW COR IN CB	DY 3168
BASELINE (1990)	110.224	L & B 1FT W BCR @ SW COR DE PALMA ST & PARAMOUNT BLVD 18FT S & 74FT W C/L INT	DY 3173
BASELINE (1990)	111.240	L & BRAD 1FT W BCR @ NW COR CLETA ST & PARAMOUNT BLVD 18FT N & 75FT W C/L INT	DY 3174
BASELINE (1990)	112.061	L&T 2FT W/O BCR @ SW COR BROOKMILL RD & PARAMOUNT BLVD 18FT S & 77FT W/O C/L INT	DY 3175
BASELINE (1990)	115.722	LACS MON IN WELL @ C/L INT 2ND ST & PARAMOUNT BLVD (USE S EDGE)	DY 3182

QUAD-YEAR	ELEV	DESCRIPTION (INCLUDE QUAD AND YEAR IN DESCRIPTION)	BM NUMBER
BASELINE (1990)	123.851	L & T 2FT S BCR @ SW COR PARAMOUNT BLVD & FARM ST 55FT S & 38FT W C/L INT	DY 3183
BASELINE (1990)	175.592	CS BR CAP MON 3FT SW OF C/L INT NORWALK BLVD & WHITTIER BLVD TO THE N MKD (WHITTIER B-2 RE 329 1949)	DY 3253
BASELINE (1990)	166.352	L&BR W CB 2FT S/O BCR @ NW COR ROSEHEDGE DR & NORWALK BLVD 54FT N & 33FT W/O C/L INT	DY 3256
BASELINE (1990)	164.456	L&SPK E CB 5FT S BCR @ SE COR DUNLAP CROSSING RD (MINES BLVD) & NORWALK BLVD 38FT E & 77FT S C/L INT	DY 3257
BASELINE (1990)	161.798	L&BN E CB 1FT S BCR @ SE COR FLORY ST & NORWALK BLVD 54FT S & 38FT E/O C/L INT	DY 3260
BASELINE (1990)	160.596	RE TAG NO 2059 6FT NW OF WALK TO HSE NO 7608 50FT E/O & 112FT S/O C/L INT NORWALK BLVD & CHOISSER ST	DY 3262
BASELINE (1990)	153.705	L&BN W CB 1FT N BCR @ NW COR WADDELL ST & NORWALK BLVD 38FT W & 60FT N C/L INT	DY 3266
BASELINE (1990)	83.681	L&T 1FT N BCR @ NW COR STUDEBAKER RD & ROSECRANS AVE 81FT N & 52FT W C/L INT	DY 3364
SANTA FE (1990)	194.401	L&BRAD E CB 4FT SO OF BCR @ SE COR MILLS AVE & LAMBERT RD 52FT SO & 30FT E C/L INT	DY 3443
SANTA FE (1990)	196.490	RD HD SPK E CB 8FT SO OF BCR @ SE COR LAMBERT RD & BONAVISTA LANE 85FT SO & 18FT E C/L INT MKD (W2 455)	DY 3446
SANTA FE (1990)	227.784	L & T 4FT W BCR @ SW COR LAMBERT RD & KIBBE AVE 32FT S & 55FT W C/L INT	DY 3460
BASELINE (1990)	291.297	C S MON 100FT S C/L WHITTIER BLVD & 5FT E C/L FIRST AVE MKD (BM 3-17 1961)	DY 3471
BASELINE (1990)	292.121	L & SPK 48FT W BCR 40FT S & 90FT W C/L INT WHITTIER BLVD & FIRST AVE MKD (BM NO 2)	DY 3472
BASELINE (1990)	332.972	CS BM MON 1FT BACK OF CB @ NE COR WHITTIER BLVD & VALLEY HOME AVE 52FT N & 24FT E/O C/L INT MKD (38-1 1964)	DY 3475
BASELINE (1990)	333.992	L & BN @ S END C B 1FT N BCR 55FT N & 20FT E C/L INT WHITTIER BLVD & VALLEY HOME AVE	DY 3476
BASELINE (1990)	248.739	STATE BR CAP E END CATCH BASIN 40FT N C/L WHITTIER BLVD 266FT E C/L SCOTT AVE	DY 3491

QUAD-YEAR	ELEV	DESCRIPTION (INCLUDE QUAD AND YEAR IN DESCRIPTION)	BM NUMBER
BASELINE (1990)	248.720	L&SPK N CB OF SERVICE RD 18FT E BCR @ NE COR LA ENTRADA AVE & WHITTIER BLVD 15FT N & 61 FT E/O C/L INT SERV RD	DY 3498
BASELINE (1990)	160.549	RAM SET NR CTR CB RET ON SE COR CHOISSER ST & NORWALK BLVD 29FT S & 45FT E/O C/L INT	DY 3707
BASELINE (1990)	157.495	RAMSET IN W CB 3FT N/O BCR @ NW COR WASHINGTON BLVD & NORWALK BLVD 135FT N & 38FT W/O C/L INT	DY 3708
BASELINE (1990)	157.891	CE BR CAP FL IN ISL NW COR WASHINGTON BLVD & NORWALK BLVD 81FT N & 32FT W/O C/L INT MKD (BM 2-14A 1961 RE 5869)	DY 3709
BASELINE (1990)	220.188	RD BM TAG CB 1FT N ECR @ SE COR WHITTIER BLVD & COMSTOCK AVE 74FT S & 18FT W C/L INT	DY 3732
BASELINE (1990)	231.362	RD BM TAG CB 3FT N ECR @ SE COR WHITTIER BLVD & WASHINGTON AVE 72FT S & 15FT E C/L INT	DY 3736
BASELINE (1990)	212.712	STATE HWY BR MON FL IN ISLAND @ BC OF CURVE 200FT WLY C/L WASHINGTON BLVD 4FT NLY S CB OF ISLAND ON WHITTIER BLVD	DY 3740
LAMIRADA (1990)	300.609	RD BM TAG S CB 1FT E BCR @ SE COR IMPERIAL HWY & FIRST AVE 40FT S & 56FT E C/L INT	DY 3997
LAMIRADA (1990)	299.971	CS TRI MON IN WELL 10IN DN @ OR NEAR C/L INT IMPERIAL HWY & FIRST AVE MKD (LA HABRA B-10-A)	DY 3998
LAMIRADA (1990)	268.151	L & T IN S CB 40FT S & 48FT W/O C/L INT IMPERIAL HWY & CLEARLEN AVE IN FRONT P P NO 1254813E MKD (BM)	DY 3999
LAMIRADA (1990)	255.812	RD BM TAG E CB 1FT S BCR @ SE COR FIRST AVE & AMBER VALLEY DR 56FT S & 30 E C/L INT	DY 4006
LAMIRADA (1990)	223.194	L&BRAD S CB 11FT E BCR @ SE COR ALICANTE RD & SANTA GERTRUDES AVE 30FT S & 95FT E C/L INT	DY 4032
NORWALK (1990)	158.710	L&SPK NR SE COR CONC WK 66FT W CARMENITA RD & 81FT N C/L BEATY AVE NR SE COR OF BLDG	DY 4312
NORWALK (1990)	166.630	L&BR IN S CB LAKELAND RD 10FT W/O BCR 32FT S & 77FT W/O C/L INT LAKELAND RD & CARMENITA RD	DY 4314
NORWALK (1990)	168.637	L&T NR S EDGE OF CONC DRWY HSE NO 10762 CARMENITA RD 124FT N/O SUNDANCE AVE & 57FT E/O C/L CARMENITA RD MKD (BM)	DY 4317

QUAD-YEAR	ELEV	DESCRIPTION (INCLUDE QUAD AND YEAR IN DESCRIPTION)	BM NUMBER
BASELINE (1990)	210.443	RDBM TAG CONC @ SW COR CTR CONC PIER UPRR BRIDGE OVER WHITTIER BLVD 150FT ELY C/L WASH- INGTON BLVD	DY 4319
BASELINE (1990)	279.098	RD BM TAG SLY END RETAINING WALL ENT DR IN MARKET 36FT NLY C/L RUSSELL ST & 125FT ELY C/L INT WHITTIER BLVD & SANTA GERTRUDES AVE	DY 4321
BASELINE (1990)	279.183	STATE HWY BR CAP W END CATCH BASIN 40FT N C/L WHITTIER BLVD & 18FT W C/L PROD VIRGINIA AVE	DY 4322
NORWALK (1990)	163.314	RDBM TAG 40FT W C/L FARMENITA RD ON S P/L HSE NO 10615 400FT S/W BURETT ST IN FRONT OF PP # W4623Y	DY 6132
BASELINE (1990)	166.395	LA CO ENGR BR CAP NLY END C B 79FT N & 37FT W/O C/L INT ROSEHEDGE DR & NORWALK BLVD MKD (BM 2-16 1961 RE 5869)	DY 6247
SANTA FE (1990)	149.704	L&T S CB 1FT E BCR @ SE COR MILLS AVE & BROADWAY 20FT S & 50FT E C/L INT MKD (WZ 169)	DY 6286
SANTA FE (1990)	206.390	LA CO RD DEPT BM TAG W CB @ NO END OF CATCH BASIN 20FT W C/L COLE RD & 73FT S C/L DITTMAR DR	DY 6290
LAMIRADA (1990)	257.540	L&BN CTR CB RET @ NE COR IMPERIAL HWY & SANTA GERTRUDES AVE 50FT N & 40FT E C/L INT	DY 6308
LAMIRADA (1990)	280.812	L&T 1FT W/O BCR IN N CB S SE RD @ SW COR IMPERIAL HWY & BREEZEWOOD DR 58FT S & 35FT W/O C/L INT MKD (BM)	DY 6309
LAMIRADA (1990)	263.275	L&BRAD E CB SERVICE RD 5FT N BCR @ SE COR SANTA GERTRUDES AVE & FOSTER RD 33FT S & 71FT E/O C/L INT MKD (BM)	DY 6320
LAMIRADA (1990)	263.406	L&T E CB SERVICE RD 5FT N BCR @ NE COR SANTA GERTRUDES AVE & FOSTER RD 45FT N & 74FT E C/L INT MKD (BM)	DY 6321
LAMIRADA (1990)	250.788	CS BM BRASS DISK IN SW COR CULVERT 33FT E C/L FIRST AVE & 236FT N/O AMBER VALLEY DR MKD (BM3-15A 1961)	DY 6326
LAMIRADA (1990)	273.489	RD BM TAG W CB 1FT N BCR @ NW COR FIRST AVE & CANDLELIGHT DR 58FT N & 32FT W C/L INT	DY 6327
LAMIRADA (1990)	276.759	RD BM TAG E CB 1FT S BCR @ SE COR FIRST AVE & CANDLELIGHT DR 56FT S & 32FT E C/L INT	DY 6328

QUAD-YEAR	ELEV	DESCRIPTION (INCLUDE QUAD AND YEAR IN DESCRIPTION)	BM NUMBER
BASELINE (1990)	177.259	RDBM TAG W CB 40FT N BCR @ NW COR WHITTIER BLVD & NORWALK BLVD 105FT N & 27FT W C/L INT	DY 6627
BASELINE (1990)	201.270	CS MON FL 1FT BACK E CB BROADWAY 29FT E C/L & 108FT N C/L WHITTIER BLVD MKD (BM 1-15A 1961)	DY 6628
BASELINE (1990)	198.391	L&T N CB 0.5FT E BCR @ NW COR BROADWAY & WHITTIER BLVD 27FT N & 66FT W C/L INT	DY 6629
BASELINE (1990)	229.576	RDBM TAG N CB S SERV RD WHITTIER BLVD 125FT S C/L @ OR NR C/L PROD PENN ST	DY 6631
BASELINE (1990)	232.978	CS MON FL 1FT BACK S CB WHITTIER BLVD 31FT S/O C/L & 25FT E/O C/L PENN ST MKD (BM 1-14C 1961)	DY 6632
BASELINE (1990)	212.829	LACS MON FL IN SW COR C B 18FT N C/L N BBL WHITTIER BLVD & 86FT W C/L PICKERING AVE MKD (BM 1-14 AB 1961)	DY 6633
BASELINE (1990)	234.163	CAL HWY BR DISC @ W END OF C B 65FT W & 38FT S/O C/L INT BARTON RD & WHITTIER BLVD	DY 6635
BASELINE (1990)	248.382	LACS BM MON IN WELL 10IN DN IN DIVIDER STRIP 49FT N & 48FT E/O C/L INT WHITTIER BLVD & LA ENTRADA AVE MKD (1-11A)	DY 6636
BASELINE (1990)	274.078	CAL HWY MON FL IN SE COR C B ON N SIDE WHITTIER BLVD @ NW COR SANTA GERTRUDES AVE (TO THE SOUTH) P RUSSELL ST 40FT N/O WHITTIER BLVD & 10FT E/O SANTA GERTRUDES AVE (TO THE SOUTH)	DY 6637
BASELINE (1990)	164.618	SPK IN S CB 7FT E BCR @ SE COR MINES BLVD & NORWALK BLVD 84FT E & 38FT S C/L INT MKD (KW-28)	DY 6664
BASELINE (1990)	151.778	BT SPK W CB 8FT N BCR @ NW COR NORWALK BLVD & SLAUSON AVE 86FT N & 40FT W C/L INT	DY 6665
BASELINE (1990)	151.685	RDBM TAG E CB 2FT N BCR @ SE COR NORWALK BLVD & SLAUSON AVE 40FT E & 82FT S C/L INT	DY 6666
BASELINE (1990)	152.938	L&T E CB NORWALK BLVD 40FT E C/L ON C/L PROD BURKE ST	DY 6667
BASELINE (1990)	153.035	RDBM TAG E CB 2FT S BCR @ SE COR NORWALK BLVD & BURKE ST 40FT E & 35FT S C/L INT	DY 6668
BASELINE (1990)	147.005	L&T CONC CB NR S SIDE OF BLDG @ 10122 NORWALK BLVD 50FT E C/L & 0.2MI N TELEGRAPH RD MKD (BM)	DY 6673
BASELINE (1990)	167.295	L&T CTR CB RET @ ENT TO CANDLEWOOD CC 45FT S C/L TELEGRAPH RD @ BRAMBLEBUSH AVE	DY 6679

QUAD-YEAR	ELEV	DESCRIPTION (INCLUDE QUAD AND YEAR IN DESCRIPTION)	BM NUMBER
BASELINE (1990)	196.242	RDBM TAG 18FT E BCR @ NE COR 42FT N & 70FT E C/L DY INT VALLEY VIEW AVE & TELEGRAPH RD	6680
BASELINE (1990)	187.261	L&T 5FT E BCR @ SW COR 54FT W & 43FT S C/L INT TELEGRAPH RD & COLIMA RD MKD (BM)	DY 6681
BASELINE (1990)	188.312	RDBM TAG 5FT W BCR @ SE COR 53FT E & 43FT S C/L INT TELEGRAPH RD & COLIMA RD	DY 6682
BASELINE (1990)	253.815	L&BN S CB 2FT E/O C B 180FT E/O C/L LAMBERT RD 40FT S C/L LEFFINGWELL RD	DY 6684
BASELINE (1990)	267.086	RDBM TAG N CB 113FT E & 38FT N C/L INT LEFFING- WELL RD & FIRST AVE 2FT E FIRST C B	DY 6686
BASELINE (1990)	279.113	L&T S CB LEFFINGWELL RD 40FT S & 55FT E C/L INT TIGRINA AVE & LEFFINGWELL RD	DY 6687
BASELINE (1990)	293.746	BN @ NW COR 2FT E BCR 48FT W & 34FT N C/L INT VALLEY HOME AVE & LEFFINGWELL RD	DY 6688
SANTA FE (1990)	200.295	L&BN E CB 2FT N C B 30FT E & 257FT N C/L INT MILLS AVE & LAMBERT RD	DY 6700
SANTA FE (1990)	218.234	L&BRAD E CB 15FT S BCR @ SE COR MILLS AVE & CULLEN ST 73FT S & 30FT E C/L INT	DY 6701
SANTA FE (1990)	219.524	L&BN E CB 60FT N & 30FT E C/L INT MILLS AVE & CULLEN ST MKD (BM)	DY 6702
SANTA FE (1990)	202.144	CS MON NE COR C B 220FT N OF LAMBERT RD TO THE EAST & 41FT W/O C/L COLIMA RD MKD (BM 1-10C 1961)	DY 6708
LAMIRADA (1990)	133.625	L&BN N CB 1FT E BCR @ NE COR ASHGROVE DR & STAN- TON AVE 30FT N & 50FT E/O C/L INT MKD (BM)	DY 6998
LAMIRADA (1990)	132.847	L&BN W CB 1FT N BCR @ SW COR ASHGROVE DR & STANTON AVE 44FT S & 20FT W C/L INT MKD (BM)	DY 6999
BASELINE (1990)	162.372	L&BRAD ELY CB 12FT S BCR @ NELY COR VALLEY VIEW AVE & LEFFINGWELL RD 88FT N & 42FT E C/L INT	DY 7008
LAMIRADA (1990)	225.502	L & T IN W CB 40FT N/O N EDGE C B 32FT W & 1500 FT S C/L INT SANTA GERTRUDES AVE & FOSTER RD 260FT N/O AVENIDA SANTA TECLA MKD (BM)	DY 7009
LAMIRADA (1990)	228.900	L&BR N CB ALICANTE RD 40FT W BCR @ NW COR ALICANTE RD & SANTA GERTRUDES AVE 87FT W & 20FT N C/L INT	DY 7010

QUAD-YEAR	ELEV	DESCRIPTION (INCLUDE QUAD AND YEAR IN DESCRIPTION)	BM NUMBER
BASELINE (1990)	65.125	RR SPK IN CONC IN NE ABUT TO RR BR 9/40 300FT SLY SERVICE RD OF SANTA ANA FRWY & 1500FT WLY VALLEY VIEW AVE	DY 7015
BASELINE (1990)	65.873	COE BR CAP FL IN SE COR BR ON SERVICE RD OF SANTA ANA FRWY ABT 1500FT WLY VALLEY VIEW AVE MKD (CC37 BM 2-1B)	DY 7016
BASELINE (1990)	78.602	RDBM TAG ELY HDWL ON NELY COR CARMENITA RD & FIRESTONE BLVD 100FT NLY & 30FT ELY APPROX C/L INT	DY 7020
BASELINE (1990)	76.098	USC&GS MON IN S HDWL CULV 500 B ON SPRR ABT 355FT NW C/L SHOEMAKER AVE & 420FT S/O C/L FIRESTONE BLVD (S-97 1932)	DY 7022
BASELINE (1990)	94.088	CAL STATE BM MON IN CB FL WITH WK ON SW COR FIRESTONE BLVD & NORWALK BLVD 83FT S & 23FT W C/L INT	DY 7023
BASELINE (1990)	98.298	USC&GS DISK VERT IN WALL OF FORMER BANK OF NORWALK BLDG ON NWLY COR FRONT ST & CLARKDALE AVE MKD (V98 1932)	DY 7024
BASELINE (1990)	80.424	L&T W CB 6FT S BCR @ SW COR WOODRUFF AVE & WASHINGTON ST 50FT S & 40FT W C/L INT	DY 7027
BASELINE (1990)	72.690	CS MON 10IN DN @ NW COR ALONDRA BLVD & BELLFLOWER BLVD 33FT N & 73FT W C/L INT MKD (BM 6-7 1951)	DY 7028
BASELINE (1990)	68.987	CS MON FL @ SE COR ALONDRA BLVD & LAKEWOOD BLVD 42FT S & 187FT E C/L INT MKD (BM 6-9A 1958)	DY 7029
BASELINE (1990)	77.827	CS MON FL IN C B @ NW COR PARAMOUNT BLVD & CENTURY BLVD 90FT N & 39FT W C/L INT MKD (BM 7-2A 1961)	DY 7030
BASELINE (1990)	80.505	CS MON FL IN C B ON NW COR PARAMOUNT BLVD & HARDING AVE 40FT N & 41FT W C/L INT MKD (BM 7-3A 1961)	DY 7031
BASELINE (1990)	79.796	CS MON 10IN DN ON NW COR HARDING AVE & PARAMOUNT BLVD 95FT N & 44FT W C/L INT MKD (BELL E 11A 1960) USE E EDGE	DY 7032
BASELINE (1990)	105.539	CS REF MON IN WELL 40FT W/O C/L PARAMOUNT BLVD & 42FT S C/L PROD ALAMEDA ST MKD (BELL G 9 RM-1)	DY 7033
BASELINE (1990)	105.570	CS REF MON IN WELL 40FT W/O C/L PARAMOUNT BLVD & 38FT N/O C/L PROD ALAMEDA ST MKD (BELL G 9 RM2)	DY 7034

QUAD-YEAR	ELEV	DESCRIPTION (INCLUDE QUAD AND YEAR IN DESCRIPTION)	BM NUMBER
NORWALK (1990)	109.412	L&T N CB LEFFINGWELL RD 12FT E BCR @ NE COR LEFFINGWELL RD & MEYER RD 40FT N & 50FT E C/L INT	DY 7270
NORWALK (1990)	112.078	L&BN W CB 2FT N CB @ NW COR LOMA DR & LEFFINGWELL RD 55FT N & 20FT W C/L INT	DY 7271
BASELINE (1990)	159.090	L&BN W CB 4FT N BCR @ NW COR TELEGRAPH RD & GREENLEAF AVE 80FT N & 32FT W C/L INT MKD (BM)	DY 7449
BASELINE (1990)	67.787	L&BN S CB FIRESTONE BLVD (S FRONTAGE RD SANTA ANA FRWY) 20FT S C/L & 0.25MI W MARQUARDT AVE IN FRONT PP 1119957E MKD (BM) 21FT W/O WLY COR BLDG #13750	DY 7497
BASELINE (1990)	68.975	L&BN S CB FIRESTONE BLVD (S FRONTAGE RD SANTA ANA FRWY) 20FT S C/L IN FRONT BLDG 13700 0.25MI W MARQUARDT AVE MKD (BM)	DY 7498
BASELINE (1990)	79.903	L&BN S CB FIRESTONE BLVD (S FRONTAGE RD SANTA ANA FRWY) 20FT S C/L & 90FT W C/L CARMENITA RD OFFRAMP MKD (BM)	DY 7499
BASELINE (1990)	77.533	L&BN CONC HDWL 23FT S C/L FIRESTONE BLVD (S FRONTAGE RD SANTA ANA FRWY) IN FRONT BLDG 13146 0.3MI W CARMENITA RD MKD (BM) 40FT E LOADING DOCK	DY 7500
BASELINE (1990)	77.451	L&BN S CB FIRESTONE BLVD (S FRONTAGE RD SANTA ANA FRWY 20FT S C/L NR E P/L BLDG 13100 AUTOMATIC SPRINKLER CORP 0.3MI W CARMENITA RD MKD (BM)	DY 7501
BASELINE (1990)	78.578	L&BN CONC RET WALL ON SW COR SHOEMAKER AVE & SPRR @ COR 8FT CHAIN LINK FEN 35FT S & 44FT W C/L INT MKD (BM)	DY 7502
BASELINE (1990)	81.378	L&BN N HDWL CULV 22FT N C/L FIRESTONE BLVD (S FRONTAGE RD SANTA ANA FRWY) 0.3MI W SHOEMAKER AVE MKD (BM)	DY 7504
BASELINE (1990)	140.474	LACS MON IN SE COR C B 122FT N & 21FT W C/L INT TELEGRAPH RD & PASSONS BLVD MKD (BM 4-15A 1968)	DY 7747
BASELINE (1990)	108.752	CS REF MON IN WELL 8IN DN @ SW COR PARAMOUNT BLVD & STEWART & GRAY RD 50FT S & 50FT W/O C/L INT 1FT BK OF WK MKD (RM 1-1960)	DY 7763
BASELINE (1990)	108.030	RDBM TAG 1FT S BCR @ SW COR PARAMOUNT BLVD & BRUNACHE ST 17FT S/O & 38FT W/O C/L INT	DY 7764

QUAD-YEAR	ELEV	DESCRIPTION (INCLUDE QUAD AND YEAR IN DESCRIPTION)	BM NUMBER
BASELINE (1990)	97.329	CS REF MON IN WELL 8IN DN @ SW COR PARAMOUNT BLVD & IMPERIAL HWY 46FT S & 55FT W C/L INT MKD(RM-4 BELL F 10A 1960)	DY 7766
BASELINE (1990)	72.889	RDBM TAG 8FT N BCR INTO CB RET @ SW COR PARAMOUNT BLVD & COMPTON BLVD 59FT S & 40FT W C/L INT	DY 7768
BASELINE (1990)	75.542	L & T 40FT S BCR @ SW COR PARAMOUNT BLVD & ROSECRANS AVE 120FT S & 35FT W C/L INT	DY 7815
BASELINE (1990)	241.601	CAL DIV OF HWYS MON 15FT W BCR 38FT N & 66FT W C/L INT WHITTIER BLVD & CALIFORNIA AVE	DY 8180
BASELINE (1990)	249.228	L & BN 2FT W BCR 37FT S & 70FT W C/L INT WHITTIER BLVD & CALMADA AVE MKD (BM)	DY 8182
BASELINE (1990)	250.629	L & BN 1FT E BCR 37FT S & 29FT E C/L INT WHITTIER BLVD & CALMADA AVE MKD (BM)	DY 8183
BASELINE (1990)	259.535	LACS MON FL IN ISLE 5FT S & 43FT E C/L INT WHITTIER BLVD & OCEAN VIEW AVE MKD BM 1-11B 1966	DY 8185
BASELINE (1990)	261.519	RDBM TAG 2FT S BCR 70FT S & 45FT E C/L INT COLIMA RD & WHITTIER BLVD	DY 8187
BASELINE (1990)	232.773	L&S 11FT W BCR 38FT N & 75FT W C/L INT WHITTIER BLVD & WASHINGTON AVE	DY 8192
BASELINE (1990)	220.902	RDBM TAG 2FT W BCR 38FT S & 51FT W C/L INT WHITTIER BLVD & COMSTOCK AVE	DY 8193
BASELINE (1990)	239.058	RDBM TAG 8FT W BCR 34FT S & 64FT E C/L INT WHITTIER BLVD & PAINTER AVE	DY 8194
SANTA FE (1990)	197.684	2IN IP FL ON C/L LAMBERT RD & 145FT E C/L BONAVISTA LN USE W EDGE PIPE TAG MKD (CITY OF WHITTIER LS 2810)	DY 8206
SANTA FE (1990)	197.161	RDBM TAG 1FT N BCR INTO RET @ SW COR LAMBERT RD & COLIMA RD 70FT S & 40FT W C/L INT	DY 8207
SANTA FE (1990)	204.779	RDBM 1FT E BCR @ SE COR LAMBERT RD & COLE RD 100FT E & 32FT S C/L INT	DY 8208
SANTA FE (1990)	217.573	RDBM TAG 5FT W BCR @ SW COR LAMBERT RD & JENKINS DR 60FT W & 32FT S C/L INT	DY 8209
SANTA FE (1990)	218.030	L & T 32FT S C/L LAMBERT RD & 55FT E C/L JENKINS DR	DY 8210

QUAD-YEAR	ELEV	DESCRIPTION (INCLUDE QUAD AND YEAR IN DESCRIPTION)	BM NUMBER
SANTA FE (1990)	241.685	RDBM TAG 1FT W BCR @ NW COR LAMBERT RD & SANTA GERTRUDES AVE 96FT W & 38FT N C/L INT	DY 8211
SANTA FE (1990)	241.730	RAM SET 1FT S BCR @ SW COR LAMBERT RD & SANTA GERTRUDES AVE 59FT S & 27FT W C/L INT	DY 8212
SANTA FE (1990)	156.858	RDBM TAG 5FT N/O BCR @ NE COR MILLS AVE & MULBERRY DR 90FT N & 28FT E/O C/L INT	DY 8218
SANTA FE (1990)	149.348	L AFC MON IN WELL 6IN DN @ C/L INT MILLS AVE & BROADWAY	DY 8219
SANTA FE (1990)	133.747	RD HD SPK CTR C.B. ON NW COR MILLS AVE & CLOSE ST 52FT N & 30FT W C/L INT PAINTED (BM)	DY 8220
BASELINE (1990)	150.255	L & T 1FT S BCR @ NWLY COR TELEGRAPH RD & MILLS AVE 45FT NLY & 34FT WLY C/L INT	DY 8222
BASELINE (1990)	137.641	L & T 1FT E BCR @ NE COR TELEGRAPH RD & VICTORIA AVE 40FT N & 46FT E C/L INT	DY 8224
BASELINE (1990)	195.009	CS BM MON FL ON SW COR TELEGRAPH RD & VALLEY VIEW AVE 42FT S & 38FT W C/L INT MKD (BM 4 - 6B)	DY 8225
BASELINE (1990)	215.914	CS MON IN WELL 12IN DN 1FT BK OF WK 50FT S & 64FT W/O C/L INT LEFFINGWELL RD & LA MIRADA BLVD MKD (K9 1960)	DY 8228
BASELINE (1990)	224.600	L & BN 13FT N BCR @ NW COR LEFFINGWELL RD & STAMEY RD (NORTH) 80FT N & 18FT W/O C/L INT	DY 8229
BASELINE (1990)	224.954	L & BRAD 42FT S C/L LEFFINGWELL RD & 40FT E C/L PROD STAMEY RD (NORTH)	DY 8230
BASELINE (1990)	253.923	CS BM MON FL CTR PKWY NR C/L LEFFINGWELL RD & 170FT E C/L LAMBERT RD MKD (BM 4 - 18 1965)	DY 8231
BASELINE (1990)	266.799	CS MON FL @ SE COR LEFFINGWELL RD & FIRST AVE 53FT S & 54FT E C/L INT MKD (3 - 16B 1965)	DY 8232
BASELINE (1990)	157.471	L & BN IN E CB 1FT S/O BCR @ SE COR VALLEY VIEW AVE & LEFFINGWELL RD 60FT S & 42FT E/O C/L INT	DY 8629
BASELINE (1990)	102.921	RDBM TAG IN W CB 26FT S/O & 38FT W/O C/L INT @ VALLEY VIEW AVE & ADOREE ST TO THE E	DY 8632
BASELINE (1990)	95.084	L & T IN W CB 2FT S/O BCR @ SW COR OF VALLEY VIEW AVE & FOSTER RD 40FT W & 57FT S/O C/L INT	DY 8633
BASELINE (1990)	113.258	L & BN IN E CB 1FT N/O BCR @ NE COR VALLEY VIEW AVE & ROSECRANS AVE 77FT N/O & 40FT E/O C/L INT	DY 8634

QUAD-YEAR	ELEV	DESCRIPTION (INCLUDE QUAD AND YEAR IN DESCRIPTION)	BM NUMBER
BASELINE (1990)	111.666	L & T NR CTR CB RET @ SW COR VALLEY VIEW AVE & ROSECRANS AVE 56FT S/O & 50FT W/O C/L INT	DY 8635
BASELINE (1990)	79.802	RDBM TAG IN E CB 6FT N/O BCR @ NE COR VALLEY VIEW AVE & GANNET ST 70FT N & 38FT E/O C/L INT	DY 8636
BASELINE (1990)	79.293	RDBM TAG IN N CB 2FT W/O BCR @ NW COR VALLEY VIEW AVE & GANNET ST 26FT N & 78FT W/O C/L INT	DY 8637
BASELINE (1990)	73.975	LACS MON FL IN CONC ABUT @ NE COR BR NO1262 OVER LA MIRADA CK 46FT E/O C/L VALLEY VIEW AVE MKD (BM 1-2A 1968)	DY 8638
BASELINE (1990)	73.749	L & BN IN CHIS SQ IN W CB 40FT W/O C/L VALLEY VIEW AVE 1.5FT N/O L & T @ C/L CHANNEL OF BR # 1262 OVER LA MIRADA CREEK	DY 8639
BASELINE (1990)	66.826	L & T IN N CB 2FT E/O BCR @ NE COR OF VALLEY VIEW AVE & ALONDRA BLVD 40FT N & 76FT E/O C/L INT	DY 8640
BASELINE (1990)	57.350	RDBM TAG IN N CB 3FT W/O BCR @ NW COR VALLEY VIEW AVE & ARBOR PL 22FT N/O & 70FT W/O C/L INT	DY 8641
BASELINE (1990)	57.638	RDBM TAG IN SO END C B IN E CB 8FT N & 42FT E/O C/L INT VALLEY VIEW AVE & PARK PL	DY 8642
BASELINE (1990)	56.685	RDBM TAG IN S CB 3FT W BCR @ SW COR 22FT S 79FT W C/L INT VALLEY VIEW AVE & PARK PL	DY 8643
BASELINE (1990)	54.455	CSBM MON FL IN S END C B 4FT N/O BCR @ NW COR VALLEY VIEW AVE & ARTESIA BLVD 82FT N & 43FT W/O C/L INT MKD (BM 8-LA 1968)	DY 8644
BASELINE (1990)	54.251	RDBM TAG IN NO CB 2FT E/O BCR @ NE COR VALLEY VIEW AVE & ARTESIA BLVD 42FT N & 79FT E/O C/L INT	DY 8645
LAMIRADA (1990)	257.514	RDBM TAG IN W CB SER RD 2FT N BCR @ NW COR FIRST AVE & SHARONHILL DR 46FT N/O & 70FT W/O C/L INT	DY 8670
LAMIRADA (1990)	265.761	L & T @ BK WK 45FT N & 39FT E/O C/L INT SANTA GERTRUDES AVE & GAZEBROOK DR MKD (BM)	DY 8672
LAMIRADA (1990)	225.495	L & T E CB 40FT N/O N END C B 32FT E & 1500FT S C/L INT SANTA GERTRUDES AVE & FOSTER RD 260FT N/O AVENIDA SANTA TECLA MKD (BM)	DY 8673
LAMIRADA (1990)	181.026	RDBM TAG IN E CB 6FT N/O BCR @ NE COR SANTA GERTRUDES AVE & ROSECRANS AVE 112FT N & 30FT E/O C/L INT	DY 8674

QUAD-YEAR	ELEV	DESCRIPTION (INCLUDE QUAD AND YEAR IN DESCRIPTION)	BM NUMBER
LAMIRADA (1990)	178.426	RDBM TAG IN S CB 10FT W/O BCR @ SE COR SANTA GERTRUDES AVE & ROSECRANS AVE 61FT E & 40FT S/O C/L INT	DY 8675
LAMIRADA (1990)	163.372	RDBM TAG IN W CB 1FT N/O BCR @ NW COR SANTA GERTRUDES AVE & ASHGROVE DR 56FT N & 30FT W/O C/L INT	DY 8676
LAMIRADA (1990)	163.088	RDBM TAG IN S CB 3FT E/O BCR @ SE COR SANTA GERTRUDES AVE & ASHGROVE DR 70FT E/O & 18FT S/O C/L INT	DY 8677
NORWALK (1990)	113.151	RDBM TAG 2FT E BCR @ SE COR LEFFINGWELL RD & CARMENITA AVE 42FT S & 52FT E C/L INT	DY 8703
NORWALK (1990)	115.189	RDBM TAG 3FT E BCR @ NE COR LEFFINGWELL RD & CARMENITA AVE 42FT N & 120FT E C/L INT	DY 8704
NORWALK (1990)	111.651	L & BRAD 1FT W BCR @ NW COR LEFFINGWELL RD & LELAND AVE 42FT N & 30FT W C/L INT	DY 8705
NORWALK (1990)	112.655	RDBM TAG 6FT E BCR @ NE COR LEFFINGWELL RD & LELAND AVE 42FT N & 70FT E C/L INT	DY 8706
BASELINE (1990)	116.452	CS BM MON FL IN C B @ NW COR FIRESTONE BLVD & PARAMOUNT BLVD 125FT N & 41FT W C/L INT MKD (BM 7-8B 1970)	DY 8713
BASELINE (1990)	115.714	RDBM TAG 1FT E BCR @ NE COR FIRESTONE BLVD & PARAMOUNT BLVD 38FT N & 78FT E C/L INT	DY 8714
BASELINE (1990)	83.907	LACS MON IN WELL 10IN DN @ SE COR ROSECRANS AVE & WOODRUFF AVE 61FT S & 75FT E C/L INT MKD (BM 6-4A 1970)	DY 8718
BASELINE (1990)	140.608	CS MON IN WELL 1FT BK OF CB 2FT S/O BCR @ SW COR NORWALK BLVD & TELEGRAPH RD 41FT W & 50FT S/O C/L INT MKD (BM 2-11B)	DY 8723
BASELINE (1990)	96.537	RDBM TAG 9FT E BCR @ NE COR SAN ANTONIO DR & FIRESTONE BLVD 40FT N & 85FT E C/L INT	DY 8727
BASELINE (1990)	96.161	DIV HWY TAG 9FT E BCR INTO RET @ SW COR SAN ANTONIO DR & FIRESTONE BL 40FT S & 68FT W C/L INT	DY 8728
NORWALK (1990)	164.761	RDBM TAG 40FT W C/L CARMENITA RD FRONT OF PP NO 1334051E OPP HSE #11320 700FT N MEYER RD	DY 8730
BASELINE (1990)	110.487	CSBM MON FL 1FT S CB @ SW COR ROSECRANS AVE & VALLEY VIEW AVE 41FT S & 170FT W C/L INT MKD (BM7-60 1970) 105FT W/O BCR	DY 8737

QUAD-YEAR	ELEV	DESCRIPTION (INCLUDE QUAD AND YEAR IN DESCRIPTION)	BM NUMBER
BASELINE (1990)	158.435	LACS MON IN WELL 8IN DN 1FT W CB FACE 2FT N BCR @ NW COR TELEGRAPH RD & GREENLEAF AVE 33FT W & 78FT N C/L INT MKD (4-10 C 1970)	DY 8740
BASELINE (1990)	98.729	COE MON FL IN SE COR BRIDGE OVER SAN GABRIEL RIVER 29FT S C/L ROSECRANS AVE MKD (SG 22 1959)	DY 8743
BASELINE (1990)	82.982	CS BM IN WELL 8IN DN @ NW COR ROSECRANS AVE & STUDEBAKER RD 58FT N & 90FT W C/L INT MKD (BM 6-2 A 1970)	DY 8744
BASELINE (1990)	94.188	L&T 1FT E BCR @ NELY COR SAN ANTONIO DR & PINE ST 18FT N & 78FT E C/L INT	DY 8745
BASELINE (1990)	77.523	LACS MON IN WELL 8IN DN @ NE COR CARMENITA RD & FIRESTONE BL 32FT N & 126FT E C/L INT MKD (BM 2-2 C 1970)	DY 8747
BASELINE (1990)	117.147	RAM SET 40FT E C/L PARAMOUNT BLVD & 3FT S C/L PROD 4TH PL	DY 8748
BASELINE (1990)	117.226	CS MON IN WELL 8IN DN 1FT BK OF CB @ NW COR PARAMOUNT BLVD & 5TH ST 52FT N & 41FT W/O C/L INT MKD (BM 7-9B 1970)	DY 8749
BASELINE (1990)	121.880	RDBM TAG 1FT S BCR @ SW COR PARAMOUNT BLVD & HARPER AVE 45FT S & 40FT W C/L INT	DY 8750
BASELINE (1990)	83.335	S & L IN S CB 0.5FT W/O BCR @ SW COR BLOOMFIELD AVE & ROSECRANS AVE 42FT S & 66FT W/O C/L INT	DY 8851
BASELINE (1990)	82.724	RDBM TAG IN N CB 2.5FT W/O BCR @ NE COR BLOOMFIELD AVE & FIRESTONE BLVD (ACCESS RD) 57FT ELY C/L BLOOMFIELD & 19FT NLY C/L FIRESTONE	DY 8852
BASELINE (1990)	295.461	L&BR CTR OF CB RET @ NE COR LA HABRA BLVD & VALLEY HOME AVE 35FT N & 33FT E/O C/L INT	DY 9191
BASELINE (1990)	278.692	L&T IN S CB LEFFINGWELL RD 35FT S & 50FT W/O C/L INT TIGRINA AVE 17FT W/O BCR & SW COR	DY 9192
BASELINE (1990)	240.390	SPK & L IN CONC CB 34FT W/O BCR @ NW COR SANTA GERTRUDES AVE & LEFFINGWELL RD 82FT W & 40FT N/O C/L INT MKD (S D 729)	DY 9193
BASELINE (1990)	234.222	LAFC MON @ BK OF C B 44FT S/O C/L LEFFINGWELL RD & 8FT E/O C/L PROD EL ARCO DRIVE	DY 9194
BASELINE (1990)	224.644	LACE TAG IN S CB LEFFINGWELL RD 42FT S & 41FT E/O C/L INT SCOTT RD	DY 9195

QUAD-YEAR	ELEV	DESCRIPTION (INCLUDE QUAD AND YEAR IN DESCRIPTION)	BM NUMBER
BASELINE (1990)	224.242	C S MON IN WELL 1FT N/O N CB OF LEFFINGWELL RD 1FT E/O BCR @ NE COR STAMEY RD (NORTH) 57FT E & 43FT N/O C/L INT MKD (4-3B 1970)	DY 9197
BASELINE (1990)	187.734	CSBM MON FL 2FT BK OF CB 2FT E/O BCR @ NE COR LEFFINGWELL RD & TELEGRAPH RD 42FT N & 48FT E/O C/L INT MKD (BM 1-9D)	DY 9198
BASELINE (1990)	133.787	L AFC MON 45FT N/O C/L TELEGRAPH RD @ W END OF BRIDGE OVER L AFC CHANNEL 0.1 MI W/O VICTORIA AVE MKD (BM 109-33915 1966)	DY 9200
BASELINE (1990)	158.181	C S BM MON IN WELL 1FT BK OF CB 41FT N/O C/L TELEGRAPH RD & 20FT E/O C/L PROD TELECRON AVE MKD (4-7C 1970)	DY 9201
BASELINE (1990)	158.299	L&BR S CB TELEGRAPH RD 42FT S/O C/L & 24FT W/O C/L PROD LAUREL AVE	DY 9202
BASELINE (1990)	158.149	RD BM TAG 1FT E/O BCR @ NE COR TELEGRAPH RD & PAINTER AVE 40FT N & 62FT E/O C/L INT	DY 9203
BASELINE (1990)	158.112	L&BN 1FT W/O BCR @ NW COR TELEGRAPH RD & PAINTER AVE 40FT N & 67FT W/O C/L INT	DY 9204
SANTA FE (1990)	145.498	RD BM TAG IN N CB TELEGRAPH RD 42FT N & 26FT E/O C/L PROD SPRINGDALE AVE OPP PP #1993730E	DY 9205
BASELINE (1990)	124.536	RD BM TAG IN CONC CB 40FT N & 0.2 MI E/O INT TELEGRAPH RD & PIONEER AVE 56FT W/O CTR SP RR BRIDGE NO 1201 (7FT W/O END CB)	DY 9207
BASELINE (1990)	139.854	CS MON NEAR C/L TELEGRAPH RD 41FT W/O W ON-OFF RAMP 605 FWY 160FT E/O E END BRIDGE NO 53-213 OVER SAN GABRIEL RIVER MKD (A-6A 1941)	DY 9209
BASELINE (1990)	144.280	L AFC MON IN SIDEWK @ NW COR BRIDGE NO B 841 OVER SAN GABRIEL RIVER 27FT N/O C/L TELEGRAPH RD MKD (77-73 1952)	DY 9210
BASELINE (1990)	145.053	RDBM TAG IN W CB VALLEY VIEW AVE 42FT W/O C/L & 9FT S/O C/L CUL-DE-SAC OF CHERE DR (FROM THE W) 0.2MI S/O LEFFINGWELL RD	DY 9274
BASELINE (1990)	64.966	L&T 17FT E/O BCR @ SE COR FIRESTONE BLVD & MARQUARDT AVE 86FT E & 22FT S/O C/L INT	DY 9275
BASELINE (1990)	69.576	STATE DIVISION OF HWY'S TAG IN LEAD IN CTR OF CB RET @ NE COR ALONDRA BLVD & FIRESTONE BLVD 46FT E & 50FT N/O C/L INT	DY 9276

QUAD-YEAR	ELEV	DESCRIPTION (INCLUDE QUAD AND YEAR IN DESCRIPTION)	BM NUMBER
BASELINE (1990)	83.362	L&T 5FT N/O BCR @ SE COR BLOOMFIELD AVE & ROSECRANS AVE 43FT E & 67FT S/O C/L INT	DY 9277
BASELINE (1990)	92.541	RDBM TAG IN S CB FIRESTONE BLVD 42FT S/O C/L & 0.25MI E/O NORWALK BLVD FT OF BLDG NO 12440 OPPOSITE SADDLEBACK SQUARE SIGN	DY 9279
BASELINE (1990)	94.922	RAMSET & TAG 4FT W/O BCR @ NW COR FIRESTONE BLVD & NORWALK BLVD 38FT N & 39FT W/O C/L INT MKD (STATE OF CALIF DIVISION OF HWYS)	DY 9280
BASELINE (1990)	87.113	L&N IN ELY WALL OF C B 5FT W/O BCR @ NW COR ROSECRANS AVE & PIONEER BLVD 60FT W & 42FT N C/L INT	DY 9281
BASELINE (1990)	84.614	RAMSET CTR OF CB RET @ SW COR WOODRUFF AVE & ROSECRANS AVE 47FT S & 52FT W/O C/L INT	DY 9283
BASELINE (1990)	77.476	RDBM TAG IN W CB WOODRUFF AVE IN S WALL C B 21FT N/O BCR @ NW COR WOODRUFF AVE & WOODRUFF PL 40FT W & 57FT N/O C/L INT	DY 9284
BASELINE (1990)	68.235	CS MON IN WELL 1FT BK OF WK @ NE COR ALONDRA BLVD & CLARK AVE 55FT N & 52FT E/O C/L INT	DY 9285
BASELINE (1990)	69.590	LS TAG IN CB 11FT W/O BCR @ NW COR ALONDRA BLVD & VIRGINIA AVE 54FT W & 40FT N/O C/L INT (MKD LS 2428)	DY 9286
BASELINE (1990)	69.135	RAMSET CTR CB RET @ NE COR ALONDRA BLVD & LAKEWOOD BLVD 42FT N & 57FT E/O C/L INT	DY 9287
BASELINE (1990)	68.017	L&BR 2FT E/O BCR @ NW COR ALONDRA BLVD & PITTS AVE 42FT N & 39FT W/O C/L INT	DY 9288
BASELINE (1990)	66.152	CS MON IN WELL 1FT BK OF WK @ NE COR ALONDRA BLV & DOWNEY AVE 51FT N & 59FT E/O C/L INT MKD (BM 6-10A)	DY 9289
BASELINE (1990)	68.890	L&BN 6FT N/O BCR @ NW COR ALONDRA BLVD & ORIZABA AVE 73FT N & 28FT W/O C/L INT	DY 9290
BASELINE (1990)	68.069	CS MON FL IN S WALL C B @ NW COR PARAMOUNT BLVD & ALONDRA BLVD 42FT W & 120FT N/O C/L INT MKD (BM 6-11B 1975)	DY 9292
BASELINE (1990)	72.332	CS MON 1FT BK OF WK CTR OF CB RET @ SW COR PARA- MOUNT BLVD & COMPTON BLVD 56FT W & 50FT S/O C/L INT MKD (BM 6-13A 1970)	DY 9293
BASELINE (1990)	109.496	L&T 1FT S/O BCR @ SE COR PARAMOUNT BLVD STEWART & GRAY RD 38FT E & 76FT S/O C/L INT	DY 9295

QUAD-YEAR	ELEV	DESCRIPTION (INCLUDE QUAD AND YEAR IN DESCRIPTION)	BM NUMBER
BASELINE (1990)	103.764	L&FC TAG IN CTR OF CB RET @ NW COR PARAMOUNT BL & QUILL DR 29FT N & 47FT W/O C/L INT	DY 9296
BASELINE (1990)	90.081	L&BD 1FT S/O BCR @ SE COR PARAMOUNT BLVD & ADOREE AVE 38FT E & 44FT S/O C/L INT	DY 9298
BASELINE (1990)	152.199	RDBM TAG IN W CB NORWALK BLVD 40FT W/O C/L & 0.45MI S/O INT LOS NIETOS RD @ NLY SIDE OF NLY DR TO BLDG NO 9703 14FT S/O LITE STD NO A-436	DY 9444
BASELINE (1990)	152.014	RDBM TAG IN E CB NORWALK BLVD 40FT E/O C/L & 0.45MI S/O INT LOS NIETOS RD (S SIDE OF C B) 29FT S/O LITE STD NO A-437	DY 9445
BASELINE (1990)	251.952	RAM SET @ NE COR NEAR CTR CB RET WHITTIER BLVD & SCOTT AVE 56FT N & 28FT E/O C/L INT	DY 9447
BASELINE (1990)	246.947	CS BM MON FL IN W WALL C B 13FT W/O BCR @ NW COR WHITTIER BLVD SERV RD & BEN HUR AVE 15FT N & 55FT W/O C/L INT MKD (1-11C 1965)	DY 9448
BASELINE (1990)	229.723	L&T S CB PKWY 1FT W/O BCR @ SE COR WHITTIER BLVD SERV RD & JACMAR AVE 38FT E & 15FT S/O C/L INT SERV RD	DY 9449
LAMIRADA (1990)	298.119	CS MON IN WELL 15FT S & 8FT W/O C/L INT IMPERIAL HWY & 1ST AVE MKD (BM 3-14-1951 329)	DY 9575
BASELINE (1990)	155.866	L&T 3FT E/O BCR @ NW COR 32FT N/O C/L LOS NIETOS RD & 93FT W/O C/L NORWALK BLVD	DY 9651
BASELINE (1990)	98.389	RDBM TAG 2FT E/O BCR @ NE COR IMPERIAL HWY & PARAMOUNT BLVD 67FT E & 40FT N/O C/L INT	DY 9658
NORWALK (1990)	167.133	L&T 2FT S/O BCR @ SE COR CARMENITA RD & LAKELAND RD 42FT E & 47FT S/O C/L INT	DY 9672
NORWALK (1990)	157.219	L&T 3FT N/O BCR @ NE COR CARMENITA RD & BEATY AVE 40FT E & 71FT N/O C/L INT	DY 9673
BASELINE (1990)	132.112	RDBM TAG 1FT E/O BCR @ SE COR TELEGRAPH RD & ORR & DAY RD 40FT S & 77FT E/O C/L INT	DY 9675
BASELINE (1990)	132.506	RDBM TAG 1FT W/O BCR @ SW COR TELEGRAPH RD & ORR & DAY RD 42FT S & 77FT W/O C/L INT	DY 9676
BASELINE (1990)	61.773	L&BR 8FT E/O BCR IN CONC CB 27FT N/O C/L FIRESTONE BLVD & 75FT E/O C/L VALLEY VIEW AVE (SOUTH SIDE OF SANTA ANA FRWY)	DY 10028

QUAD-YEAR	ELEV	DESCRIPTION (INCLUDE QUAD AND YEAR IN DESCRIPTION)	BM NUMBER
BASELINE (1990)	149.353	RDBM TAG IN CONC CB 2FT N/O BCR 1 I63 5-6&3J3 TELEGRAPH RD & 32FT E/O C/L MILLS AVE	DY 10054
BASELINE (1990)	244.946	RDBM TAG E WALL C B 15FT N/O C/L SERVICE RD N SIDE WHITTIER BLVD & 47FT W/O C/L MILLS AVE 6FT W/O BCR	DY 10055
BASELINE (1990)	142.747	CALIF DIV OF HWY MON IN CB @ NW COR OF TELEGRAPH RD & PARAMOUNT BLVD 40FT N & 54FT W/O C/L INT 4FT W/O BCR MKD (K4 1941 5 1972)	DY 10201
BASELINE (1990)	138.793	RDBM TAG IN CB @ NE COR TELEGRAPH RD & LAKEWOOD BLVD 42FT N/O C/L TELEGRAPH RD & 63FT E/O C/L LAKEWOOD BLVD (1FT E/O BCR)	DY 10202
BASELINE (1990)	141.711	RDBM TAG IN CB @ SE COR TELEGRAPH RD & NORWALK BLVD 42FT S & 91FT E/O C/L INT (1FT E/O BCR)	DY 10203
BASELINE (1990)	143.049	RDBM TAG IN S CB @ SW COR TELEGRAPH RD & WILLIS ST 42FT S & 60FT W/O C/L INT (1FT W/O BCR)	DY 10204
BASELINE (1990)	151.787	RDBM TAG S CB @ SW COR TELEGRAPH RD & BLOOMFIELD AVE (TO SOUTH) 42FT S & 79FT W/O C/L INT (1FT W/O BCR)	DY 10205
BASELINE (1990)	152.275	RDBM TAG IN N CB @ NE COR TELEGRAPH RD & SANTA FE SPRINGS RD (TO NORTH) 42FT N & 79FT E/O C/L INT (1FT E/O BCR)	DY 10206
BASELINE (1990)	158.149	RDBM TAG IN CB @ NE COR TELEGRAPH RD & LAUREL AVE 50FT N & 54FT E/O C/L INT (2FT W/O BCR)	DY 10207
BASELINE (1990)	157.665	RDBM TAG IN CB @ SE COR TELEGRAPH RD & CARMENITA RD 35FT S/O TELEGRAPH RD & 90FT E/O CARMENITA RD (1FT W/O BCR)	DY 10208
BASELINE (1990)	184.815	RDBM TAG IN CB @ SE COR TELEGRAPH RD & LEFFING- WELL RD 97FT E/O C/L TELEGRAPH RD & 42FT S/O C/L LEFFINGWELL RD (1FT W/O BCR)	DY 10209
BASELINE (1990)	185.496	RDBM TAG IN CB @ NW COR LEFFINGWELL RD & ARROYO DR 42FT S & 54FT W/O C/L INT (1FT S/O BER)	DY 10210
BASELINE (1990)	76.428	DPW BM TAG W CB @ SW COR PARAMOUNT BLVD & ROSE ST 33FT S/O & 42FT W/O C/L INT (1FT N/O BCR)	DY 10220
BASELINE (1990)	134.550	DPW BM TAG E CB @ NE COR PARAMOUNT BLVD & GALLATIN RD 38FT E/O & 64FT N/O C/L INT 1FT S/O BCR	DY 10221

QUAD-YEAR	ELEV	DESCRIPTION (INCLUDE QUAD AND YEAR IN DESCRIPTION)	BM NUMBER
BASELINE (1990)	68.322	RDBM TAG IN S CB @ SE COR ALONDRA BLVD & PARAMOUNT BLVD 68FT E & 43FT S/O C/L INT (8FT W/O BCR)	DY 10222
BASELINE (1990)	67.244	DPW BM TAG IN S CB @ SW COR ALONDRA BLVD & HAYTER AVE 42FT S & 25FT W/O C/L INT (1FT W/O BCR)	DY 10223
BASELINE (1990)	69.436	DPW BM TAG IN N CB @ NE COR ALONDRA BLVD & VIRGINIA AVE 42FT N & 51FT E/O C/L INT (1FT E/O BCR)	DY 10224
BASELINE (1990)	84.897	DPW BM TAG IN N CB @ NW COR ROSECRANS AVE & FLATBUSH AVE 38FT N & 75FT W/O C/L INT (1FT W/O BCR)	DY 10225
BASELINE (1990)	84.713	DPW BM TAG IN N CB @ NE COR ROSECRANS AVE (SERVICE RD) & FAIRFORD AVE 15FT N & 42FT E/O C/L INT (1FT E/O BCR)	DY 10226
BASELINE (1990)	64.197	DPW BM TAG @ SE COR CONC SLAB TO TRAFFIC SIGNAL LIGHT 43FT W & 34FT N/O C/L INT FIRESTONE BLVD & VALLEY VIEW AVE	DY 10227
BASELINE (1990)	117.269	MWP RP TAG IN SO CB 71FT W & 42FT S/O C/L INT VALLEY VIEW AVE & IMPERIAL HWY (1FT E/O BCR @ SW COR)	DY 10240
BASELINE (1990)	264.466	L&BRAD IN CB 53FT E/O C/L COLE RD & 38FT S/O C/L WHITTIER BLVD (1FT E/O BCR)	DY 10250
BASELINE (1990)	238.189	RAMSET IN CB @ MCR SW COR WHITTIER BLVD & PAINTER AVE 44FT S & 60FT W/O C/L INT	DY 10251
BASELINE (1990)	233.168	DPW BM TAG IN SW COR C B @ NE COR WHITTIER BLVD & MAGNOLIA AVE (TO THE NORTH) 40FT N & 54FT E/O C/L INT (32FT E/O BCR)	DY 10252
BASELINE (1990)	231.819	DPW BM TAG IN CB @ NW COR WHITTIER BLVD & MAGNOLIA AVE (TO THE NORTH) 40FT N & 130FT W/O C/L INT (1FT W/O BCR)	DY 10253
BASELINE (1990)	169.465	1&BRAD IN CB @ SW COR NORWALK BLVD & LOCH AVON DR 38FT S & 29FT W/O C/L INT (8FTN/O BCR)	DY 10259
BASELINE (1990)	263.755	RDBM TAG IN CB 2FT E/O BCR 42FT N/O C/L WHITTIER BLVD & 90FT E/O C/L COLIMA RD	DY 10371